



FEDERAL SIGNAL
Safety and Security Systems

Low Hook-On Mounting Kit for Allegiant™

Installation Instructions

25500468

Rev. A1 0820

© Copyright 2018-2020 Federal Signal Corporation

Limited Warranty

This product is subject to and covered by a limited warranty, a copy of which can be found at www.fedsig.com/SSG-Warranty. A copy of this limited warranty can also be obtained by written request to Federal Signal Corporation, 2645 Federal Signal Drive, University Park, IL 60484, email to info@fedsig.com or call +1 708-534-3400.

This limited warranty is in lieu of all other warranties, express or implied, contractual or statutory, including, but not limited to the warranty of merchantability, warranty of fitness for a particular purpose and any warranty against failure of its essential purpose.



FEDERAL SIGNAL

Safety and Security Systems

2645 Federal Signal Drive
University Park, Illinois 60484

www.fedsig.com

Customer Support

Police/Fire-EMS: 800-264-3578 • +1 708 534-3400

Work Truck: 800-824-0254 • +1 708 534-3400

Technical Support 800-433-9132 • +1 708 534-3400

All trademarks are property of their respective owners.

Contents

Safety Messages	4
Introduction.....	6
Unpacking the Kit.....	6
Preparing the Mounting Plate Assembly.....	7
Installing the Mounting Foot on the Light Bar.....	7
Installing the Light Bar on the Vehicle Roof	9
Getting Technical Support.....	11
Getting Repair Service.....	11
Ordering Replacement Parts.....	11

Tables

Table 1 Kit Contents.....	5
---------------------------	---

Figures

Figure 1 Preparing the mounting plate.....	7
Figure 2 Securing the foot to the light bar.....	8
Figure 3 Inboard position for the mounting foot on the vehicle	9
Figure 4 Outboard position for the mounting foot on the vehicle	9

Safety Messages

Safety Messages

Safety Messages to Installers and Users of Warning Light Equipment

WARNING

People's lives depend on your safe installation of our products. It is important to read, understand and follow all instructions shipped with the products. Listed below are some other important safety instructions and precautions you should follow:

- To properly install the lighting system, you must have a good understanding of automotive systems, along with proficiency in the installation and use of safety warning equipment.
- If a vehicle seat is temporarily removed, verify with the vehicle manufacturer if the seat needs to be recalibrated for proper airbag deployment.
- When drilling into a vehicle structure, ensure that both sides of the surface are clear of anything that could be damaged. All drilled holes should be deburred and all sharp edges should be smoothed. All wires going through drilled holes should be protected by a grommet or convolute/split-loom tubing. Additionally, all exterior drilled holes must be sealed with Motorcraft seam sealer T-A-2-B or equivalent to prevent the potential exposure to carbon monoxide or other potentially harmful fumes. Failure to observe this warning could cause serious injury or death.
- Refer to the instructions included with the light system for the proper electrical connections.
- To be an effective warning device, this product produces bright light that can be hazardous to your eyesight when viewed at close range. Do not stare directly into this lighting product at close range, or permanent damage to your eyesight may occur.
- Frequently inspect the light system to ensure that it is operating properly and is securely attached to the vehicle.

- Refer to the instructions packed with related products for additional precautions and information.
- File these instructions in a safe place and refer to them when maintaining or reinstalling the product.

Failure to follow all safety precautions and instructions may result in property damage, serious injury, or death.

Unpacking the Kit

Introduction

This publication provides instructions for installing the Low Hook-On Mounting Kit. A vehicle-specific mounting hook that completes the installation is purchased separately. The Low Hook mount is not suitable for use with the External Opticom, 795H-EXT-D or 795H-EXT-P.

Unpacking the Kit

After unpacking the product, inspect it for damage that may have occurred in transit. If it has been damaged, do not attempt to install or operate it. File a claim immediately with the carrier, stating the extent of damage. Carefully check all envelopes, shipping labels, and tags before removing or destroying them. Ensure that the parts listed in Table 1 are included in the package.

Table 1 Kit contents

Qty.	Description	Part Number
2	Foot, Low	864901847
4	Pad, Low Foot, Algt	865302554
8	Spacer, Low Foot	864901849
2	Plate, Mtg, Low	864901850
2	Retainer, Nut	8583490
8	Scr, PLASTITE® Eq, #10 6-Lobe, Stl, Blk	70000612-12
8	Bolt, Crg, 5/16-18, Sqr Neck	7004025-14
8	Nut, 5/16-18, Hi-Corr. Resi	7059125
8	Wash, Flt, SS, 0.344 X 3/4 X 0.05	7072A031
8	Lkwash, Split 5/16-inch Screw, SS	7074A020
2	Nut, Flange, 5/16-18, Hi-Corr. Resi	7065078
4	Scr, #10 Typ B, 6 Lobe, Stl, Blk	7011246-08

Preparing the Mounting Plate Assembly

Secure the flange nut to the mounting plate using the nut retainer and two #10 Type B screws. Do not overtighten. Repeat for the other side. See Figure 1.

Figure 1 Preparing the mounting plate

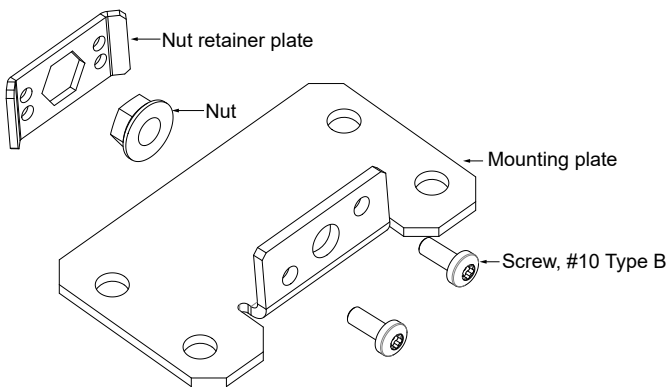

Installing the Mounting Foot on the Light Bar

Refer to the installation and maintenance instructions included with the light bar for electrical installation instructions. Plan all cable routing before the installation.

⚠ WARNING

HEAVY OBJECT: Use lifting aids and proper lifting techniques when removing or replacing this product. Failure to follow this warning may cause personal injury.

To install the mounting foot on the light bar:

1. Place the light bar upside down on soft rags or cardboard to avoid marring the plastic domes.
2. Insert two 5/16-18 carriage bolts into each track (four total) through the center access holes in the light bar. See Figure 2.

Installing the Mounting Foot on the Light Bar

Figure 2 Securing the foot to the light bar

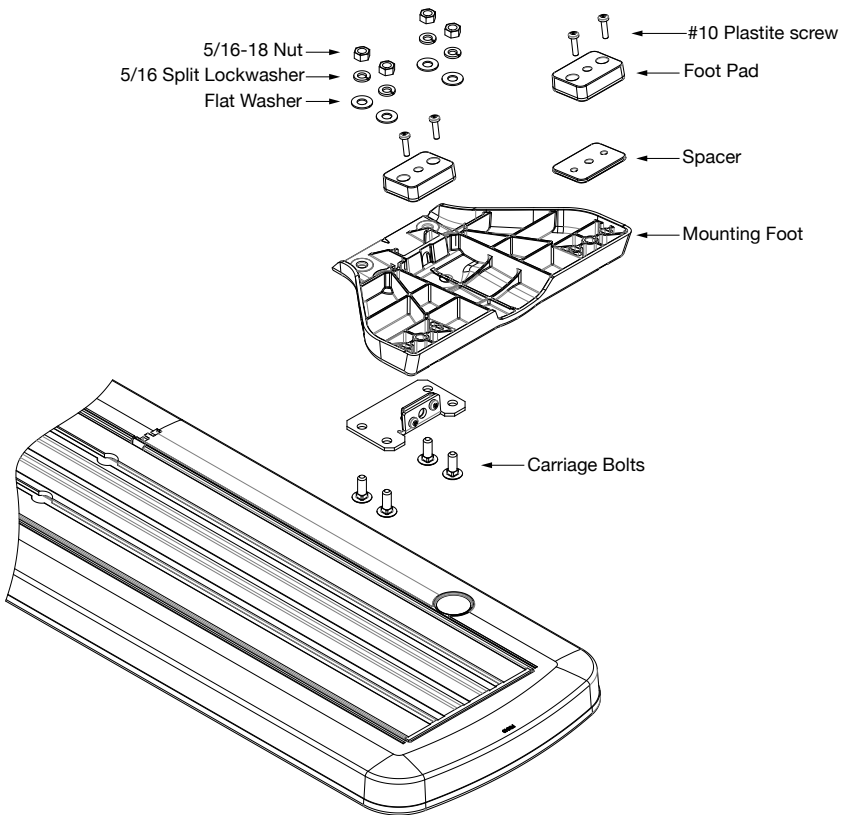

3. Position the bolts to match the holes in the mounting foot.
4. Place the prepared mounting plate assembly and foot over the four carriage bolts. Install four flat washers, lock washers, and 5/16-18 nuts on the carriage bolts, leaving the nuts just loose enough to reposition the mounting foot. Do not tighten the nuts yet.
5. Start with a pad on the rear and one spacer and one pad to the front, and temporarily attach them to the mounting foot with tape.
6. Repeat steps 1 through 5 on the other side of the light bar.

Installing the Light Bar on the Vehicle Roof

To install the light bar on the vehicle roof:

1. Place the light bar assembly on the vehicle roof at the selected location. Usually the light bar assembly should be installed so that the mounting hooks attach at the door center post (B-pillar). Before proceeding, see the instructions provided with the separately purchased mounting hook kit.
2. Adjust both mounting foot assemblies in or out as necessary until the foot pads rest near the edge of the roof or gutter where the roof is the most rigid. See Figures 3 and 4.

Figure 3 Inboard position for the mounting foot on the vehicle

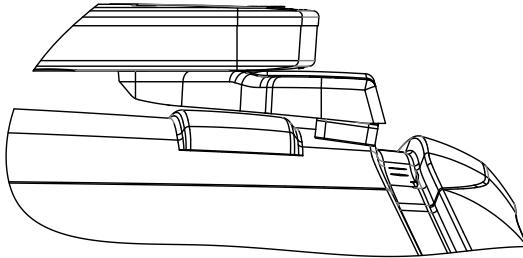
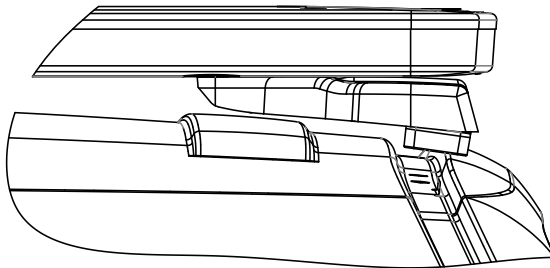

Figure 4 Outboard position for the mounting foot on the vehicle



3. The bar should be slightly nose down 1-2 degrees, approximately 1/4 inch. To adjust it, use additional spacers and/or reposition the light bar assembly slightly forward or backward. Verify that there is no contact that may mar or damage the roof. Add spacers as necessary. If adequate clearance cannot be obtained, use the standard mount foot kit (8653134).

Installing the Light Bar on the Vehicle Roof

4. Remove the light bar from the vehicle roof and place it on soft rags or cardboard to avoid damaging the plastic domes.

NOTICE

PROPERLY TIGHTEN NUTS: To avoid damaging the light bar, do not overtighten the nuts.

5. Turn the light bar over so that the bottom faces up. Torque the nuts on the four 5/16-inch bolts on each mounting foot 120 in-lb to 132 in-lb.
6. Secure the foot pads and spacers with the #10 PLASTITE® screws.
7. Place the light bar on the vehicle roof in the selected position.
8. To fasten the mounting hook, refer to the instructions included with the Keeper Plate Kit.

Getting Technical Support

For technical support, please contact:

Federal Signal Corporation

Phone: 1-800-443-9132

Fax: 1-800-343-9706

Email: empserviceinfo@fedsig.com

Getting Repair Service

The Federal Signal factory provides technical assistance with any problems that cannot be handled locally.

Any units returned to Federal Signal for service, inspection, or repair must be accompanied by a Return Material Authorization (RMA). Obtain an RMA from a Local Distributor or Manufacturer's Representative. Provide a brief explanation of the service requested or the nature of the malfunction.

Address all communications to the following address.

Federal Signal Corporation

Service Department

2645 Federal Signal Drive

University Park IL 60484-3167

Ordering Replacement Parts

To order replacement parts, call Customer Support at 1-800-264-3578, 7 a.m. to 5 p.m., Monday through Friday (CT) or contact your nearest distributor.



FEDERAL SIGNAL
Safety and Security Systems

2645 Federal Signal Drive
University Park, Illinois 60484

www.fedsig.com

Customer Support

Police/Fire-EMS:

Work Truck:

Technical Support

800-264-3578 • +1 708 534-3400

800-824-0254 • +1 708 534-3400

800-433-9132 • +1 708 534-3400